

- Ideal insulation for post frame building applications
- Quick and easy to install, while adding R-value
- Reduces heat loss and heat gain all year round
- Can block up to 97% of radiant heat transfer

INSTALLATION METHOD

1. If Trusses or wall posts are 48" or greater on center, add wood furring strips in the 'cross' direction to wall posts and roof trusses.
2. Unroll rFOIL™ insulation horizontally - in the direction of the furring strips - and staple into place.
3. To ensure a continuous insulation system, seal all seams and butt joints with rFOIL™ tape.

Builder's Notes:

- If a white interior finish is desired, rFOIL™ poly reflective insulation may be used. Install as per usual method, however with poly-white side facing interior.
- Use rFOIL™ white poly tape to seal all seams and butt joints.
- When rFOIL™ insulation comes in direct contact with ACQ lumber, it may discolour. This will not affect the overall insulation value of rFOIL™ insulation.

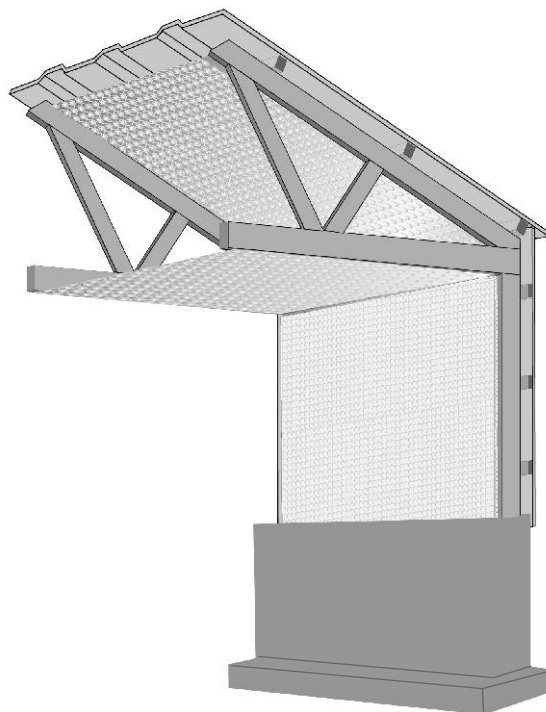

SUGGESTED PRODUCTS FOR THIS APPLICATION:

- | | |
|------------------------|---|
| REFLECTIVE INSULATION | › 2200 or 2500 series - available in various dimensions |
| rFOIL™ REFLECTIVE TAPE | › 15213 (reflective), 15853 (white poly) |

* Check local building codes for compliance before installation. This installation sheet is intended solely to illustrate the proper location and placement of rFOIL™ Reflective Insulation products in specific constructions applications. They are not intended to illustrate proper construction methods (which is ultimately the responsibility of the builder or contractor). The installation instructions are only recommendations relating to the location and placement of rFOIL™ Reflective Insulation products, and rFOIL™ makes no claims that these construction systems are universally accurate.

** All warranties and performance estimates are void if rFOIL™ Reflective Insulation products are used in exterior applications, or in non-enclosed systems or buildings.

*** Exercise caution when using rFOIL™ Reflective Insulation products near and around electrical wiring and devices.



- Ideal for Mini Storage buildings with flat, gable, and single slope roofing
- Quick and easy to install, while adding R-value
- Reduces heat loss and heat gain all year round
- Can block up to 97% of radiant heat transfer

INSTALLATION METHOD

1. Measure distance from eave to eave.
2. To ensure rFOIL™ insulation is applied level and in-line, snap a chalk line along the length that the insulation will run.
3. Cut a piece of rFOIL™ insulation slightly longer than the length measured in step (1). This extra length will allow the material to drape between purlins.
4. Apply double-sided tape to both eaves. Unroll rFOIL™ insulation from the ridge, draping material between purlins. Allow material sag approximately $\frac{3}{4}$ " to create the necessary airspace.
5. Fasten material to eave using double-sided tape. If necessary, use mechanical fasteners such as self tapping screws.
6. Install first metal roofing piece as per manufacturer's instructions.
7. Repeat steps 3-6 for the remainder of the insulation and roofing.
8. Seal all seams and butt joints using rFOIL™ tape to ensure a continuous vapour barrier.

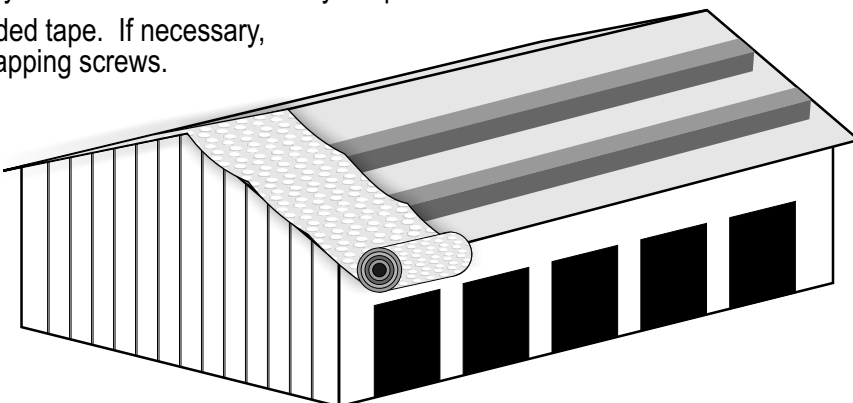

SUGGESTED PRODUCTS FOR THIS APPLICATION:

- | | |
|------------------------|---|
| REFLECTIVE INSULATION | › 2200 or 2500 series - available in various dimensions |
| rFOIL™ REFLECTIVE TAPE | › 15213 (reflective), 15853 (white poly) |

* Check local building codes for compliance before installation. This installation sheet is intended solely to illustrate the proper location and placement of rFOIL™ Reflective Insulation products in specific constructions applications. They are not intended to illustrate proper construction methods (which is ultimately the responsibility of the builder or contractor). The installation instructions are only recommendations relating to the location and placement of rFOIL™ Reflective Insulation products, and rFOIL™ makes no claims that these construction systems are universally accurate.

** All warranties and performance estimates are void if rFOIL™ Reflective Insulation products are used in exterior applications, or in non-enclosed systems or buildings.

*** Exercise caution when using rFOIL™ Reflective Insulation products near and around electrical wiring and devices.



- Ideal insulation for post frame building applications
- Quick and easy to install, and adds R-value
- Reduces heat loss and heat gain all year round
- Can block up to 97% of radiant heat transfer

INSTALLATION METHOD #1

1. Starting at end truss, attach rFOIL™ insulation securely over purlins.
2. As you unroll the insulation, allow it to drape slightly between purlins.
3. Attach the product to the purlins using staples, and seal all seams with rFOIL™ tape.
4. Affix roofing panels as usual- creating an enclosed air space between insulation and the roof itself.

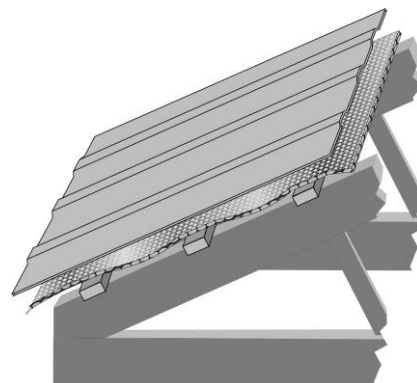

INSTALLATION METHOD #2

1. Attach rFOIL™ insulation to purlins of the building wall, and unroll product vertically.
2. As the insulation is unrolled, allow it to slightly drape between each purlin.
3. Attach product to purlins using staples and seal all seams with rFOIL™ tape.
4. Affix roofing panels as usual – creating an enclosed airspace between insulation and the roof itself.

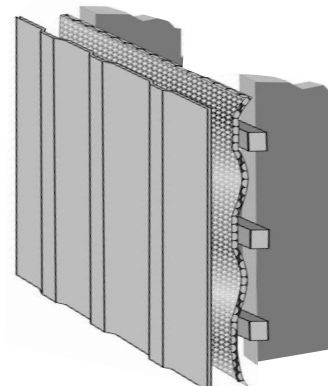

SUGGESTED PRODUCTS FOR THIS APPLICATION:

- | | |
|------------------------|---|
| REFLECTIVE INSULATION | › 2200 or 2500 series - available in various dimensions |
| rFOIL™ REFLECTIVE TAPE | › 15213 (reflective), 15853 (white poly) |

* Check local building codes for compliance before installation. This installation sheet is intended solely to illustrate the proper location and placement of rFOIL™ Reflective Insulation products in specific constructions applications. They are not intended to illustrate proper construction methods (which is ultimately the responsibility of the builder or contractor). The installation instructions are only recommendations relating to the location and placement of rFOIL™ Reflective Insulation products, and rFOIL™ makes no claims that these construction systems are universally accurate.

** All warranties and performance estimates are void if rFOIL™ Reflective Insulation products are used in exterior applications, or in non-enclosed systems or buildings.

*** Exercise caution when using rFOIL™ Reflective Insulation products near and around electrical wiring and devices.



- Ideal insulation for metal frame building applications
- Quick and easy to install, and adds R-value
- Reduces heat loss and heat gain all year round
- Can block up to 97% of radiant heat transfer

INSTALLATION METHOD #1 - Ceiling Installation

1. Use double-coated tape to temporarily attach reflective insulation to purlins.
2. Attach metal or wood strips perpendicular to purlins every 24" using mechanical or shot fasteners.
3. Seal all seams and joints with rFOIL™ reflective tape.
4. Leave at least 12" around the perimeter for ventilation.
5. All water pipes should be below the insulation to help prevent winter freeze.

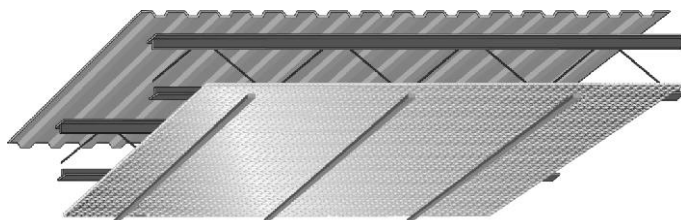

INSTALLATION METHOD #2 - Wall Installation

1. Use metal channels to attach reflective insulation with screws.
2. As an alternative method - use double-coated tape to attach reflective insulation to purlins temporarily, then screw metal attachment strips into place every 24".
3. Seal seams with rFOIL™ reflective tape.

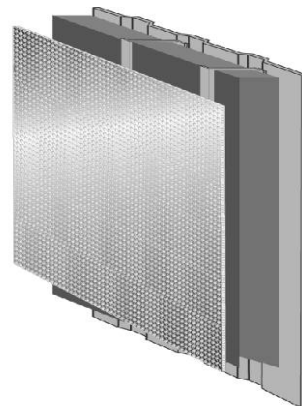

SUGGESTED PRODUCTS FOR THIS APPLICATION:

- | | |
|------------------------|---|
| REFLECTIVE INSULATION | › 2200 or 2500 series - available in various dimensions |
| rFOIL™ REFLECTIVE TAPE | › 15213 (reflective), 15853 (white poly) |

* Check local building codes for compliance before installation. This installation sheet is intended solely to illustrate the proper location and placement of rFOIL™ Reflective Insulation products in specific constructions applications. They are not intended to illustrate proper construction methods (which is ultimately the responsibility of the builder or contractor). The installation instructions are only recommendations relating to the location and placement of rFOIL™ Reflective Insulation products, and rFOIL™ makes no claims that these construction systems are universally accurate.

** All warranties and performance estimates are void if rFOIL™ Reflective Insulation products are used in exterior applications, or in non-enclosed systems or buildings.

*** Exercise caution when using rFOIL™ Reflective Insulation products near and around electrical wiring and devices.



- Ideal insulation for metal frame building applications
- Quick and easy to install, and adds R-value
- Reduces heat loss and heat gain all year round
- Can block up to 97% of radiant heat transfer

INSTALLATION METHOD #1 - Drape Method

1. Begin attaching rFOIL™ Reflective Insulation by first applying double-sided tape on the C or Z channels.
2. Unroll the product, allowing it to sag between channels creating a 3/4" air space.
3. Apply rFOIL™ tape to seams or use the Quick-Seam tab (if available).
4. Attach metal roofing as usual - creating an enclosed air space between insulation and the wall covering itself.

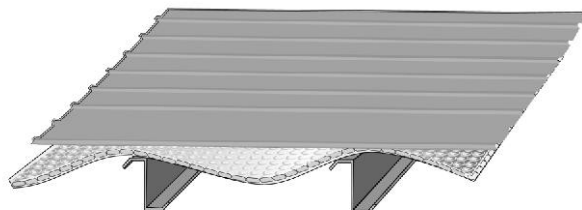

INSTALLATION METHOD #2 - Purlin Method

1. Beginning at end purlin, attach rFOIL™ Reflective Insulation - double-sided tape can be used if necessary to temporarily hold the product in place.
2. Unroll the reflective insulation, pull tight and continue mounting product to purlins.
3. Apply rFOIL™ reflective tape to seams or use Quick-Seam tabs, if they are available.
4. Attach 3/4" - 1" strapping overtop of the insulation.
5. Attach metal roofing as per usual method creating an enclosed air space between roofing and insulation.

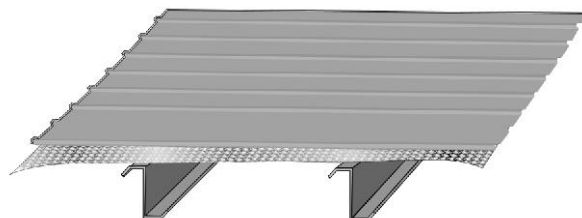

SUGGESTED PRODUCTS FOR THIS APPLICATION:

- | | |
|------------------------|---|
| REFLECTIVE INSULATION | › 2200 or 2500 series - available in various dimensions |
| rFOIL™ REFLECTIVE TAPE | › 15213 (reflective), 15853 (white poly) |

* Check local building codes for compliance before installation. This installation sheet is intended solely to illustrate the proper location and placement of rFOIL™ Reflective Insulation products in specific constructions applications. They are not intended to illustrate proper construction methods (which is ultimately the responsibility of the builder or contractor). The installation instructions are only recommendations relating to the location and placement of rFOIL™ Reflective Insulation products, and rFOIL™ makes no claims that these construction systems are universally accurate.

** All warranties and performance estimates are void if rFOIL™ Reflective Insulation products are used in exterior applications, or in non-enclosed systems or buildings.

*** Exercise caution when using rFOIL™ Reflective Insulation products near and around electrical wiring and devices.



- Ideal insulation for metal frame building applications
- Quick and easy to install, and adds R-value
- Reduces heat loss and heat gain all year round
- Can block up to 97% of radiant heat transfer

INSTALLATION METHOD #1 - Drape Method

1. Begin attaching rFOIL™ Reflective Insulation by first applying double-sided tape on the C or Z channels.
2. Unroll the product, allowing it to sag between channels creating a 3/4" air space.
3. Apply rFOIL™ reflective tape to seams or use the Quick-Seam tab (if available).
4. Attach metal roofing as usual - creating an enclosed air space between insulation and the wall covering itself.

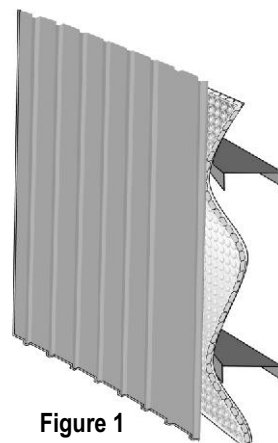

Figure 1

INSTALLATION METHOD #2 - Purlin Method

1. Beginning at end purlin, attach rFOIL™ Reflective Insulation - double-sided tape can be used if necessary to temporarily hold the product in place.
2. Unroll the reflective insulation, pull tight and continue mounting product to purlins.
3. Apply rFOIL™ reflective tape to seams or use Quick-Seam tabs, if they are available.
4. Attach 3/4" - 1" strapping overtop of the insulation.
5. Attach wall panels as per usual method creating an enclosed air space between product panels and insulation.

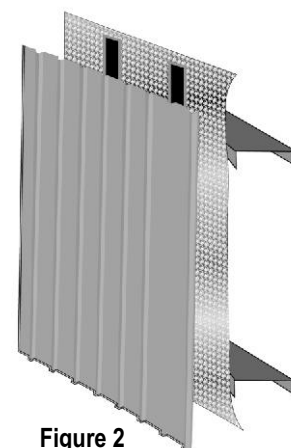

Figure 2

SUGGESTED PRODUCTS FOR THIS APPLICATION:

- | | |
|------------------------|---|
| REFLECTIVE INSULATION | › 2200 or 2500 series - available in various dimensions |
| rFOIL™ REFLECTIVE TAPE | › 15213 (reflective), 15853 (white poly) |

* Check local building codes for compliance before installation. This installation sheet is intended solely to illustrate the proper location and placement of rFOIL™ Reflective Insulation products in specific constructions applications. They are not intended to illustrate proper construction methods (which is ultimately the responsibility of the builder or contractor). The installation instructions are only recommendations relating to the location and placement of rFOIL™ Reflective Insulation products, and rFOIL™ makes no claims that these construction systems are universally accurate.

** All warranties and performance estimates are void if rFOIL™ Reflective Insulation products are used in exterior applications, or in non-enclosed systems or buildings.

*** Exercise caution when using rFOIL™ Reflective Insulation products near and around electrical wiring and devices.





INSTALLATION SHEET

METAL BUILDING RE-ROOF APPLICATION

www.rFOIL.com

- Ideal insulation for metal frame building applications
- Quick and easy to install, and adds R-value
- Reduces heat loss and heat gain all year round
- Can block up to 97% of radiant heat transfer

INSTALLATION METHOD

1. Attach appropriate furring strips onto existing ribbed metal roof.
2. Pull rFOIL™ insulation tight and lay across furring strips with Quick-Seam tab on the leading edge (if applicable). Allow draping between the furring strips.
3. Lay next strip of insulation parallel to the first. Slide this strip beneath tab and use Quick-Seam tab to seal the joint (if applicable). Seal all seams and joints with rFOIL™ reflective tape.
4. Lay new roof on top of insulation and affix as per manufacturer's instructions.

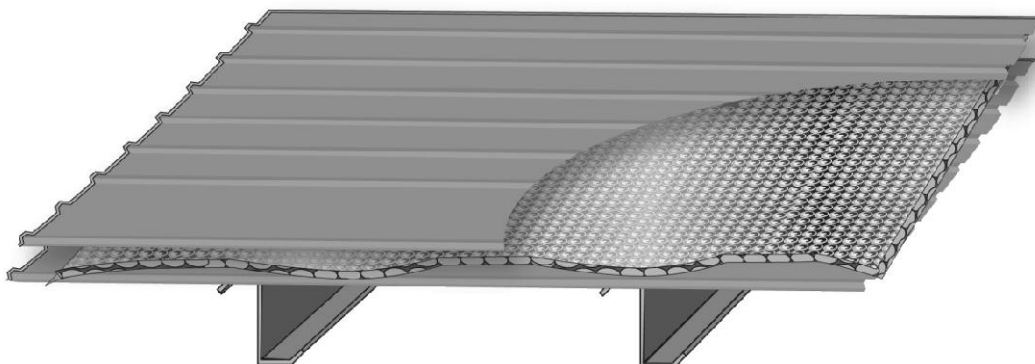

SUGGESTED PRODUCTS FOR THIS APPLICATION:

- | | |
|------------------------|---|
| REFLECTIVE INSULATION | › 2200 or 2500 series - available in various dimensions |
| rFOIL™ REFLECTIVE TAPE | › 15213 (reflective), 15853 (white poly) |

* Check local building codes for compliance before installation. This installation sheet is intended solely to illustrate the proper location and placement of rFOIL™ Reflective Insulation products in specific constructions applications. They are not intended to illustrate proper construction methods (which is ultimately the responsibility of the builder or contractor). The installation instructions are only recommendations relating to the location and placement of rFOIL™ Reflective Insulation products, and rFOIL™ makes no claims that these construction systems are universally accurate.

** All warranties and performance estimates are void if rFOIL™ Reflective Insulation products are used in exterior applications, or in non-enclosed systems or buildings.

*** Exercise caution when using rFOIL™ Reflective Insulation products near and around electrical wiring and devices.



- Ideal insulation for metal frame building applications
- Quick and easy to install, and adds R-value
- Reduces heat loss and heat gain all year round
- Can block up to 97% of radiant heat transfer

INSTALLATION METHOD - Ceiling Installation

1. Use double-coated tape to temporarily attach reflective insulation to purlins.
2. Attach metal or wood strips perpendicular to purlins every 24" using mechanical or shot fasteners.
3. Seal all seems and joints with rFOIL™ reflective tape.
4. Leave at least 12" around the perimeter for ventilation.
5. All water pipes should be below the insulation, to help prevent winter freeze.

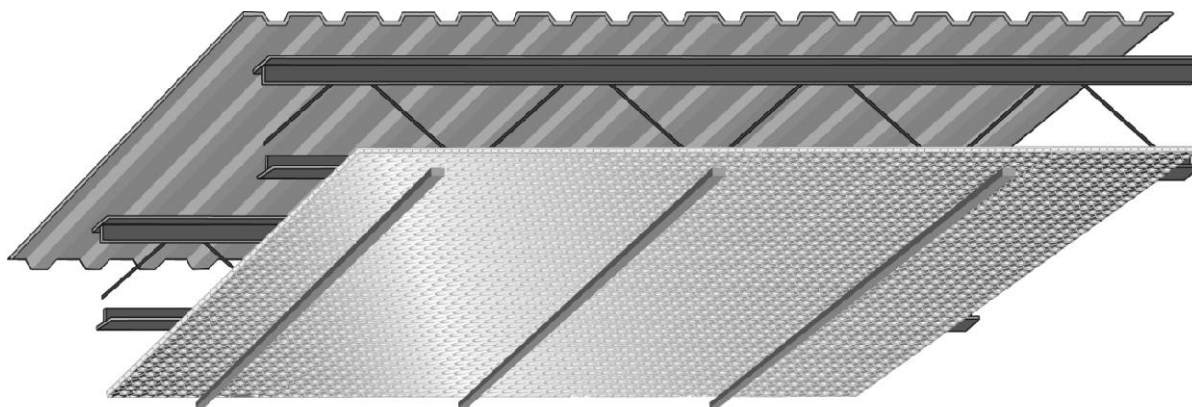

SUGGESTED PRODUCTS FOR THIS APPLICATION:

- | | |
|------------------------|---|
| REFLECTIVE INSULATION | › 2200 or 2500 series - available in various dimensions |
| rFOIL™ REFLECTIVE TAPE | › 15213 (reflective), 15853 (white poly) |

* Check local building codes for compliance before installation. This installation sheet is intended solely to illustrate the proper location and placement of rFOIL™ Reflective Insulation products in specific constructions applications. They are not intended to illustrate proper construction methods (which is ultimately the responsibility of the builder or contractor). The installation instructions are only recommendations relating to the location and placement of rFOIL™ Reflective Insulation products, and rFOIL™ makes no claims that these construction systems are universally accurate.

** All warranties and performance estimates are void if rFOIL™ Reflective Insulation products are used in exterior applications, or in non-enclosed systems or buildings.

*** Exercise caution when using rFOIL™ Reflective Insulation products near and around electrical wiring and devices.



- Ideal insulation for metal frame building applications
- Quick and easy to install, and adds R-value
- Reduces heat loss and heat gain all year round
- Can block up to 97% of radiant heat transfer

INSTALLATION METHOD

1. Starting at the ridge, unroll rFOIL™ insulation perpendicular to the purlins.
2. Using 1 ¼" self-tapping screws, attach end of the roll to ridge (screws spaced 8" apart).
3. Continue installing insulation towards roof's edge, allowing the insulation to sag approximately ¾" between purlins.
4. Unroll the second roll of insulation as in step (1) and attach the two sections together using the Quick-Seam tab (if applicable), or rFOIL™ tape.
5. Install first course of metal roofing section, in accordance with the manufacturer's instructions.
6. Repeat steps 1-5 for the remainder of the roof.

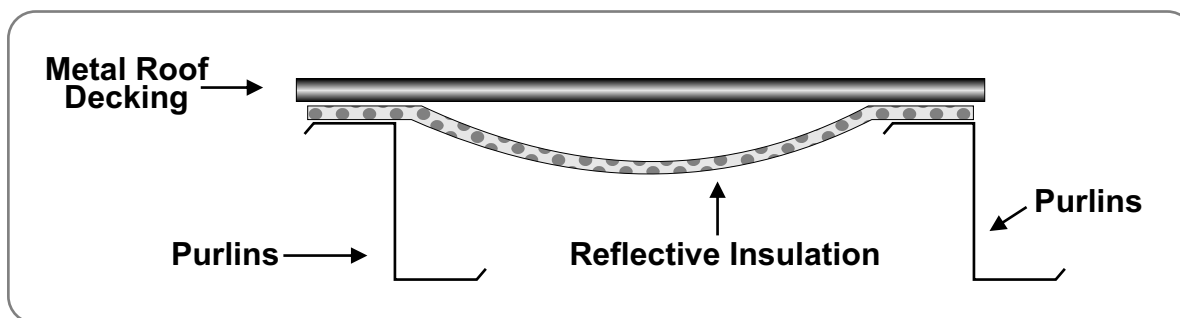

SUGGESTED PRODUCTS FOR THIS APPLICATION:

- | | |
|------------------------|---|
| REFLECTIVE INSULATION | › 2200 or 2500 series - available in various dimensions |
| rFOIL™ REFLECTIVE TAPE | › 15213 (reflective), 15853 (white poly) |

* Check local building codes for compliance before installation. This installation sheet is intended solely to illustrate the proper location and placement of rFOIL™ Reflective Insulation products in specific constructions applications. They are not intended to illustrate proper construction methods (which is ultimately the responsibility of the builder or contractor). The installation instructions are only recommendations relating to the location and placement of rFOIL™ Reflective Insulation products, and rFOIL™ makes no claims that these construction systems are universally accurate.

** All warranties and performance estimates are void if rFOIL™ Reflective Insulation products are used in exterior applications, or in non-enclosed systems or buildings.

*** Exercise caution when using rFOIL™ Reflective Insulation products near and around electrical wiring and devices.



- Ideal insulation for metal frame building applications
- Quick and easy to install, and adds R-value
- Reduces heat loss and heat gain all year round
- Can block up to 97% of radiant heat transfer

INSTALLATION METHOD

1. Install 3.5" of mass insulation (R-11), and metal roofing as usual.
2. Working from the inside of the building, fasten one end of rFOIL™ insulation to the ridge using 1 ¼" self-tapping screws spaced 8" apart.
3. Unroll the insulation and attach purlin using 1 ¼" self-tapping screws, 8" apart.
4. Continue installing insulation across the purlins working your way to the end of the building. To prevent buckling, pull the insulation material tight between purlins.
5. Install the remaining rolls of insulation in accordance with steps 1-4.
6. Seal all seams and joints using the appropriate rFOIL™ tape (white or reflective).

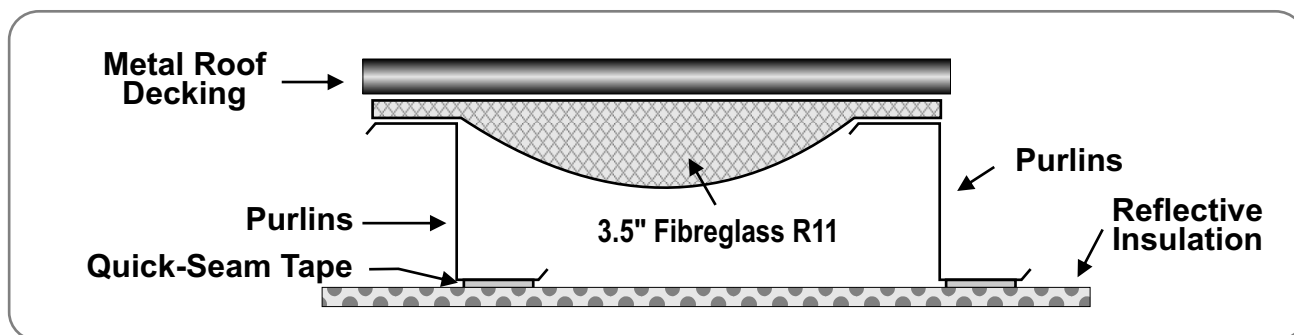

SUGGESTED PRODUCTS FOR THIS APPLICATION:

- | | |
|------------------------|---|
| REFLECTIVE INSULATION | › 2200 or 2500 series - available in various dimensions |
| rFOIL™ REFLECTIVE TAPE | › 15213 (reflective), 15853 (white poly) |

* Check local building codes for compliance before installation. This installation sheet is intended solely to illustrate the proper location and placement of rFOIL™ Reflective Insulation products in specific constructions applications. They are not intended to illustrate proper construction methods (which is ultimately the responsibility of the builder or contractor). The installation instructions are only recommendations relating to the location and placement of rFOIL™ Reflective Insulation products, and rFOIL™ makes no claims that these construction systems are universally accurate.

** All warranties and performance estimates are void if rFOIL™ Reflective Insulation products are used in exterior applications, or in non-enclosed systems or buildings.

*** Exercise caution when using rFOIL™ Reflective Insulation products near and around electrical wiring and devices.



- Ideal insulation for metal frame building applications
- Quick and easy to install, and adds R-value
- Reduces heat loss and heat gain all year round
- Can block up to 97% of radiant heat transfer

INSTALLATION METHOD

1. Install 6" of mass insulation (R-19), and metal roofing as usual.
2. Working from the inside of the building, fasten one end of rFOIL™ insulation to the ridge using 1 ¼" self-tapping screws spaced 8" apart.
3. Unroll the insulation and attach purlin using 1 ¼" self-tapping screws, 8" apart.
4. Continue installing insulation across the purlins working your way to the end of the building. To prevent buckling, pull the insulation material tight between purlins.
5. Install the remaining rolls of insulation in accordance with steps 1-4.
6. Seal all seams and joints using the appropriate rFOIL™ tape (white or reflective).

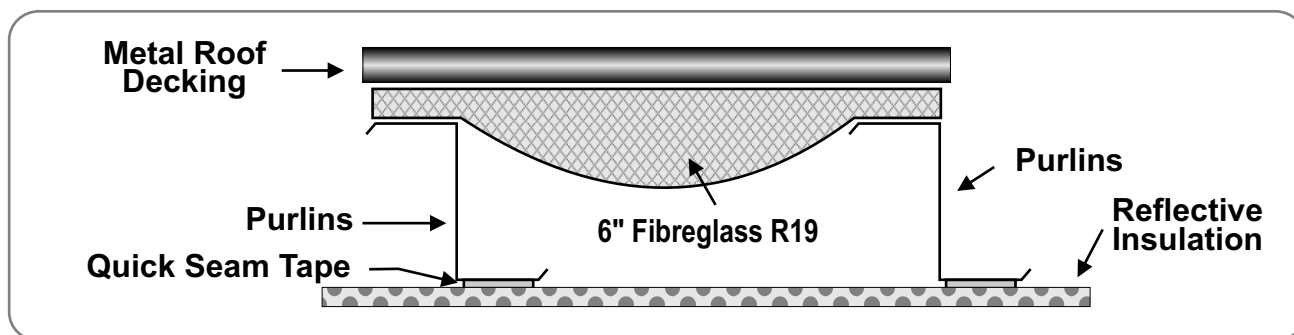

SUGGESTED PRODUCTS FOR THIS APPLICATION:

- | | |
|------------------------|---|
| REFLECTIVE INSULATION | › 2200 or 2500 series - available in various dimensions |
| rFOIL™ REFLECTIVE TAPE | › 15213 (reflective), 15853 (white poly) |

* Check local building codes for compliance before installation. This installation sheet is intended solely to illustrate the proper location and placement of rFOIL™ Reflective Insulation products in specific constructions applications. They are not intended to illustrate proper construction methods (which is ultimately the responsibility of the builder or contractor). The installation instructions are only recommendations relating to the location and placement of rFOIL™ Reflective Insulation products, and rFOIL™ makes no claims that these construction systems are universally accurate.

** All warranties and performance estimates are void if rFOIL™ Reflective Insulation products are used in exterior applications, or in non-enclosed systems or buildings.

*** Exercise caution when using rFOIL™ Reflective Insulation products near and around electrical wiring and devices.





INSTALLATION SHEET

RADIANT HEATING IN A CONCRETE FLOOR

www.rFOIL.com

- Directs heat up – towards the living space
- Increases efficiency of radiant heating systems
- Excellent vapor and radon barrier
- Quick and easy to install – reduces labour costs

INSTALLATION METHOD

1. Unroll rFOIL™ insulation onto floor (white poly side up, if applicable).
2. Butt the seams and seal all joints with rFOIL™ white poly tape.
3. Install radiant heating system as per manufacturer's instructions.
4. Proceed with concrete pour as usual - ensuring a thickness of a least 3".

Builders Note:

Adding 1" of sand over rFOIL™ insulation will facilitate water drainage and may reduce the curing time.

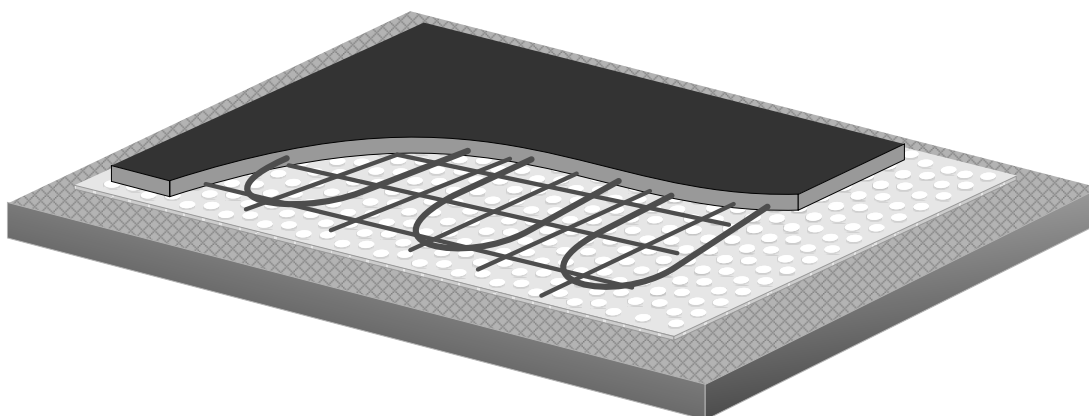

SUGGESTED PRODUCTS FOR THIS APPLICATION:

- | | |
|------------------------|---|
| REFLECTIVE INSULATION | › 1620-48-125, 4320-48-125, 1320-48-125 |
| rFOIL™ REFLECTIVE TAPE | › 15853 (white poly) |

* Check local building codes for compliance before installation. This installation sheet is intended solely to illustrate the proper location and placement of rFOIL™ Reflective Insulation products in specific constructions applications. They are not intended to illustrate proper construction methods (which is ultimately the responsibility of the builder or contractor). The installation instructions are only recommendations relating to the location and placement of rFOIL™ Reflective Insulation products, and rFOIL™ makes no claims that these construction systems are universally accurate.

** All warranties and performance estimates are void if rFOIL™ Reflective Insulation products are used in exterior applications, or in non-enclosed systems or buildings.

*** Exercise caution when using rFOIL™ Reflective Insulation products near and around electrical wiring and devices.



- Helps to direct heat up towards cold surface
- Increases efficiency of radiant heating systems
- Excellent vapor and radon barrier
- Quick and easy to install – reduces labour costs

INSTALLATION METHOD

1. Unroll rFOIL™ insulation – cover entire area to be heated (white poly side up, if applicable).
2. Butt the seams and seal all joints with rFOIL™ white poly tape.
3. Install radiant heating system as per manufacturer's instructions.
4. Proceed with concrete pour as usual – ensuring a thickness of at least 3”.

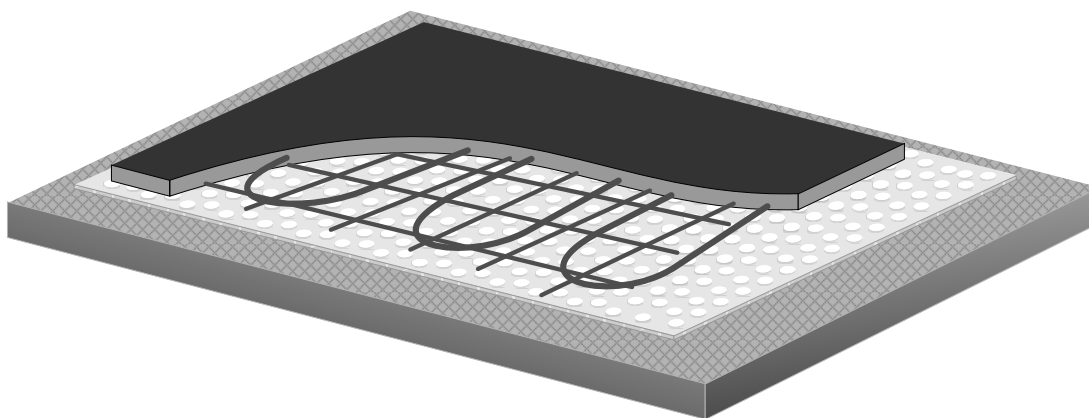

SUGGESTED PRODUCTS FOR THIS APPLICATION:

- | | |
|------------------------|----------------------------|
| REFLECTIVE INSULATION | › 1620-48-125, 1320-48-125 |
| rFOIL™ REFLECTIVE TAPE | › 15853 (white poly) |

* Check local building codes for compliance before installation. This installation sheet is intended solely to illustrate the proper location and placement of rFOIL™ Reflective Insulation products in specific constructions applications. They are not intended to illustrate proper construction methods (which is ultimately the responsibility of the builder or contractor). The installation instructions are only recommendations relating to the location and placement of rFOIL™ Reflective Insulation products, and rFOIL™ makes no claims that these construction systems are universally accurate.

** All warranties and performance estimates are void if rFOIL™ Reflective Insulation products are used in exterior applications, or in non-enclosed systems or buildings.

*** Exercise caution when using rFOIL™ Reflective Insulation products near and around electrical wiring and devices.





INSTALLATION SHEET

BENEATH A CONCRETE SLAB

www.rFOIL.com

- Helps to reduce basement dampness and increase comfort
- Reduces heat loss to the ground below
- Excellent vapor and radon barrier
- Compressive strength of 140 PSI
- Quick and easy to install – helps to keep floors warm

INSTALLATION METHOD

1. Unroll rFOIL™ Ultra CBF over gravel, dirt or alternative sub-material prior to concrete pour.
2. Seal the seams and butt joints using rFOIL™ white poly tape - ensuring a continuous vapor barrier.
3. Proceed with concrete pour as usual method.

Builders Note:

Adding 1" of sand over Ultra CBF will facilitate water drainage and reduce actual curing time.

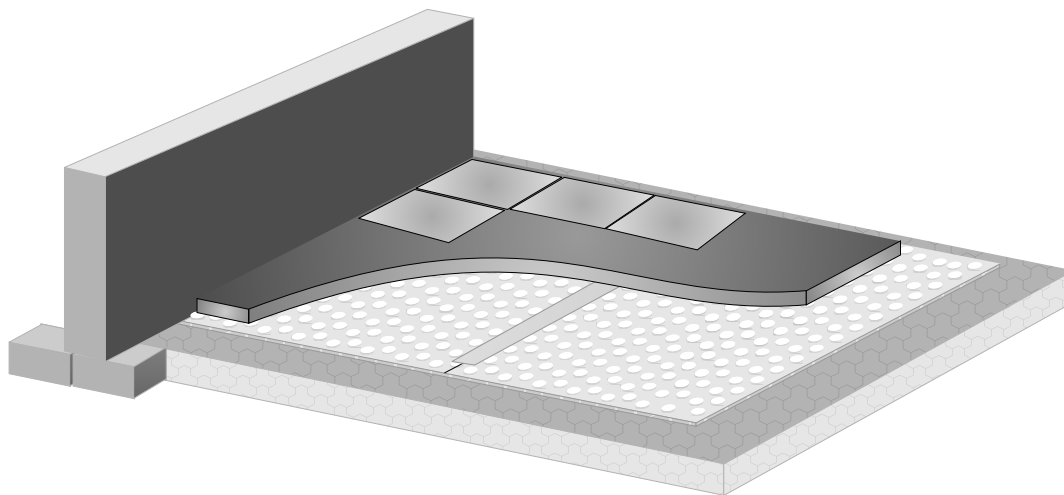

SUGGESTED PRODUCTS FOR THIS APPLICATION:

- | | |
|------------------------|-----------------------------|
| REFLECTIVE INSULATION | › 1620-48-125, (48" x 125') |
| rFOIL™ REFLECTIVE TAPE | › 15853 (3" wide) |

* Check local building codes for compliance before installation. This installation sheet is intended solely to illustrate the proper location and placement of rFOIL™ Reflective Insulation products in specific constructions applications. They are not intended to illustrate proper construction methods (which is ultimately the responsibility of the builder or contractor). The installation instructions are only recommendations relating to the location and placement of rFOIL™ Reflective Insulation products, and rFOIL™ makes no claims that these construction systems are universally accurate.

** All warranties and performance estimates are void if rFOIL™ Reflective Insulation products are used in exterior applications, or in non-enclosed systems or buildings.

*** Exercise caution when using rFOIL™ Reflective Insulation products near and around electrical wiring and devices.

